

NEW CREATION WORKS LTD.

FOKUZ Installation Instruction



FOKUZ 5

- ⚠** Please read these instructions carefully before installation.
- 🔧** This instruction has 3 major parts
1. Important Safety Notes
 2. Fixture Assembly
 3. Lamp Assembly / Re-lamping

For servicing in Singapore contact:

CTA CONTROL TECH ASIA PTE. LTD.
Lighting & Control for Architectural & Theatrical Spaces
45 Genting Lane #03-02, Genting Complex, Singapore 349557
Tel: +65-67420181 Fax: +65-67491681
Email: info@controltechasia.com
Website: www.controltechasia.com
Company No.: 200802342R

1. Important Safety Notes

- This is a recessed fixture and should be installed to a non-flammable surface by a certified technician only.
- This product is IP20 rated and should only be used indoors.
- Before installation, make sure the power rating is compatible to the product label, otherwise the product may be damaged or experience electric shock and cause fire.
- Do not disassemble the fixture or perform repair on your own. FOKUZ will not be responsible for any damage or accidents due to unauthorized repair.
- User will bear all risks if product is not used for its intended purpose.
- This sign  means that any object being lit must have a minimum distance of the specified requirement.
- Product must be properly grounded.
- During re-lamping, power must be disconnected.
- The lamp can be extremely hot during operation and should be cooled down before making contact.
- When re-lamping, make sure the replacement bulb is compatible to the specifications of the product.
- The sign  means that the product must use self-shielded lamps only.
- The cutout in the ceiling must be 245 +5/-0mm.
- Do not cover the fixture with any object to prevent damage or cause of fire.

2. Fixture Assembly

- Make sure the power is compatible to the product label.
- Make sure the power to the cables are not live and disconnected from the power source.
- Make sure the cables are correctly connected to the designated output

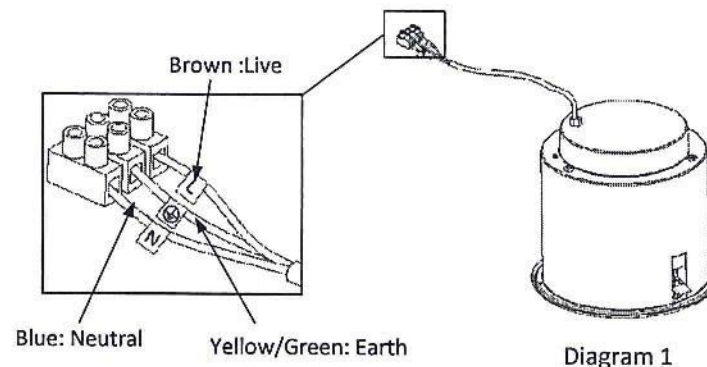

- Before installation, the ceiling should have an opening of 245 +5/-0mm. Please refer to Dia. 2 and loosen the screws in clockwise direction. As the screw is being loosened, the flap will extend out and move upwards.

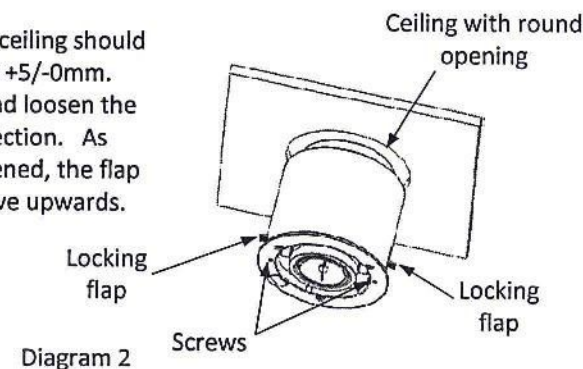

- Please refer to Dia. 3. As the screw is being tightened clockwise, the flap will extend out and down until it locks the fixture to the ceiling. (Note that the ceiling must not be thicker than 25mm.)

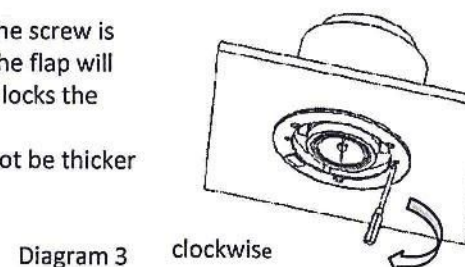

- When assembling the bezel to the fixture, make sure the rectangular opening on the bezel matches to the LCD display window. Must make sure the 4 locking clips are clicked into position. Refer to Dia. 4. and Dia. 5.

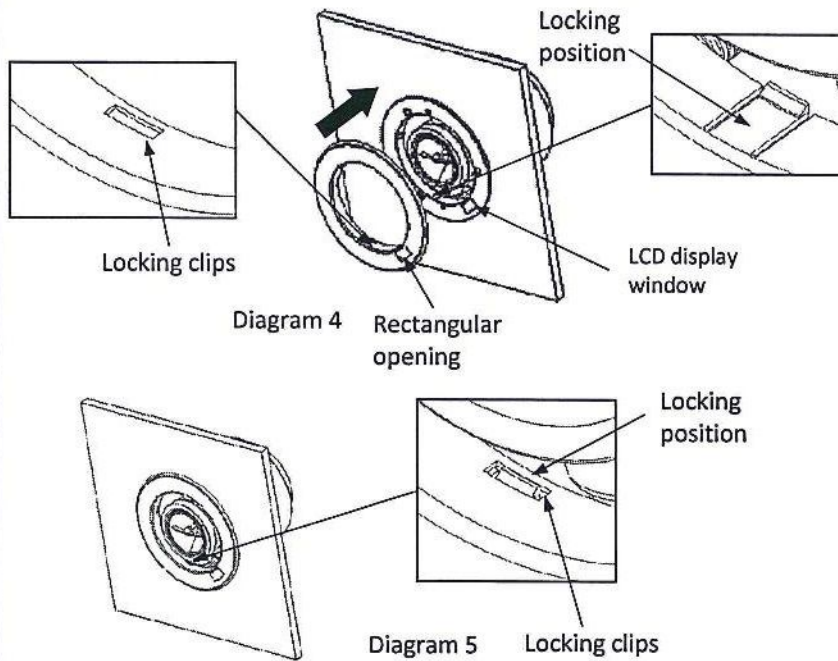

3. Lamp Assembly / Re-lamping

- When re-lamping, use the FOKUZ controller to extend the lamp holder assembly down from the ceiling. Refer to Dia. 6. Turn counter clockwise to loosen the lamp holder bezel.

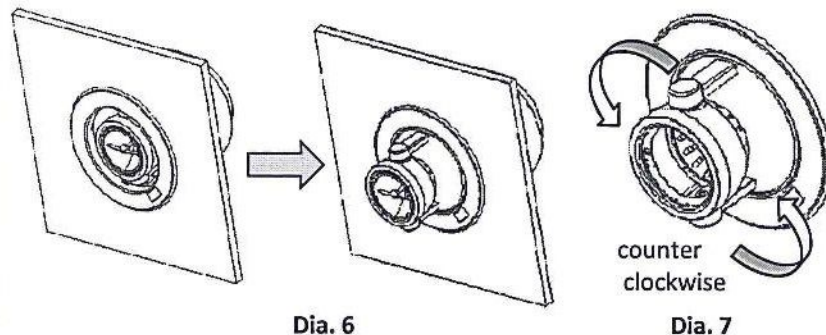

- Using LED AR111 or Halogen AR111 lamps:

These 2 lamp types are connected using fork connectors. When assembling, make sure the fork connectors are pushed in as close to the screws on the lamp as possible. The lamp can be put back into the lamp head

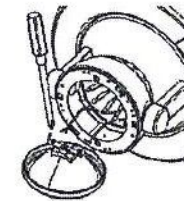

- Using CDM R111 Metal Halide lamps:

This lamp uses GX8.5 lamp holders and the lamp should be twisted into position. The map can be put back into the lamp

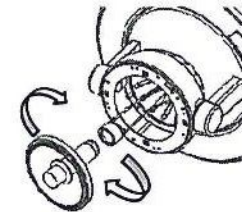

- Assembling the lamp holder bezel:

- As shown in the below diagram, the screws must align to the key slot in order to be locked.



- Turn the bezel as in the below diagram to lock tightly.

